

IR36-6B

36" (6) Open Burner Restaurant Range

The Inferno 36" 6 burner range is strong and durable, perfect for busy commercial kitchens. Units can be specified in natural gas or liquid propane. Ranges come with liftoff anti-clogging burners, and ovens come standard with 2 chrome racks, and will accommodate 18" x 26" sheet pans.



Features

- 6 burner configuration
- 30,000 BTU/hr anti-clogging lift-off burner heads
- 35,000 BTU/hr oven
- Oven temperatures from 175°F to 500°F
- 2 chrome racks included
- 5" casters with locks on front
- Fits 18" x 26" sheet pans
- Porcelain oven interior for easy cleaning
- Units available in natural gas or liquid propane
- 1 year parts and labour warranty

IR36-6B

36" (6) Open Burner Restaurant Range

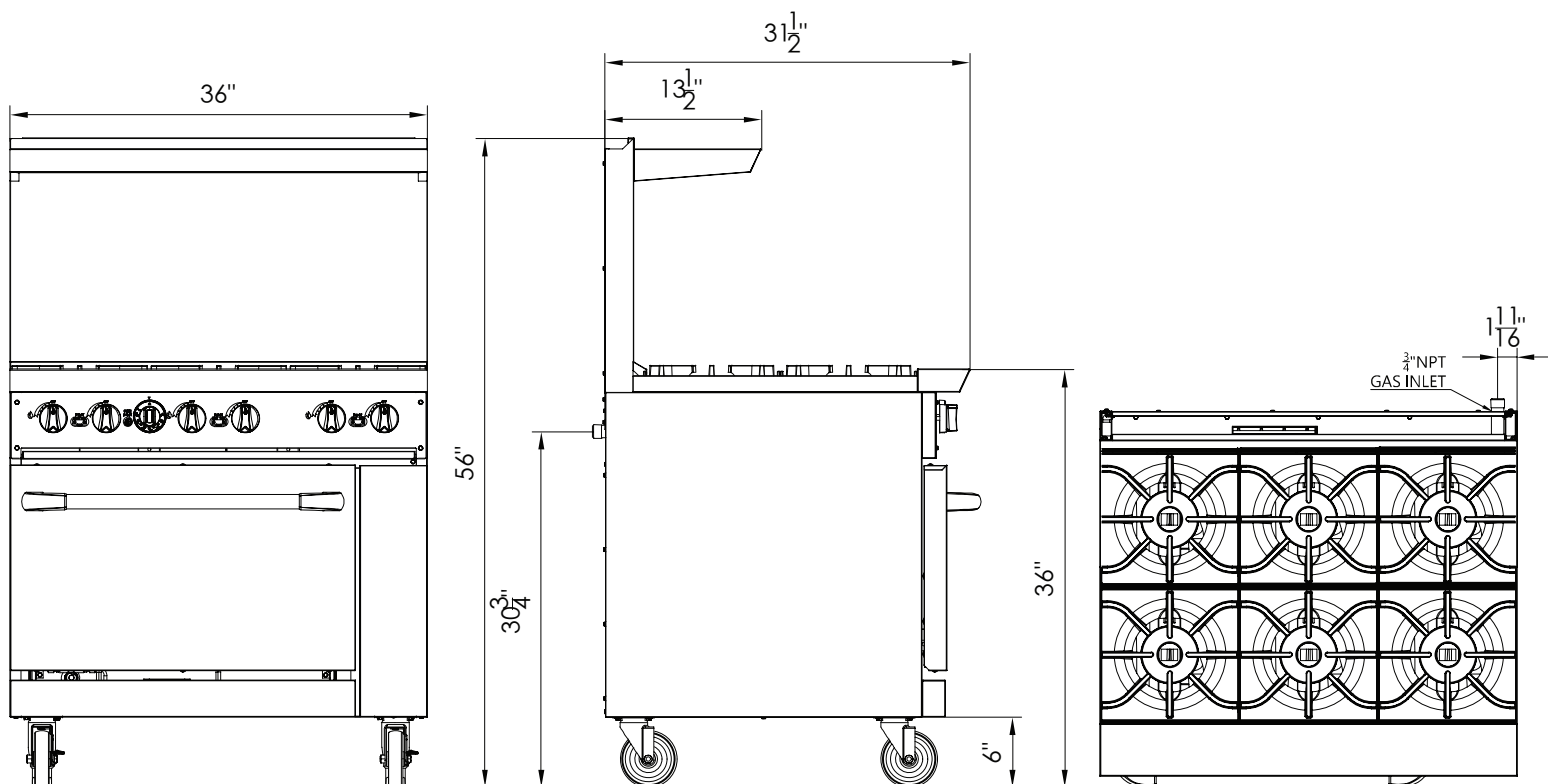

FRONT

LEFT

TOP

Model	External Dimensions (inches)			Crated Dimensions (inches)			Net Weight	Gross Weight	Gas Source	Burner Count		Single Burner	Total Output (BTU)	Orifice Size	Gas Pressure
	W	D	H	W	D	H				Open Burner	Oven				
IR36-6B	36	31 1/2	56	38	36 4/5	41 7/8	384.96	438.68	LPG	Open Burner	6	30000	215000	52	10 in. WC
										Oven	1	35000		49	
									NAT	Open Burner	6	33000	233000	41	5 in. WC
										Oven	1	35000		38	

Specifications are subject to change without notice.